

The Municipal District of Bonnyville has retained **Accurate Assessment Group Ltd.** to drive all the roads in the municipality in both directions during August and September 2016.



## WHY VDC

Safe capture and cost efficient view of road and roadside assets on Municipality's computer system.

A vehicle equipped with 3 cameras linked to a location, captures and maintains roadside GIS information.



- Signs, culverts, sidewalks, guardrails, fire hydrants, road surfaces, single line road network, Property Pictures (urban).

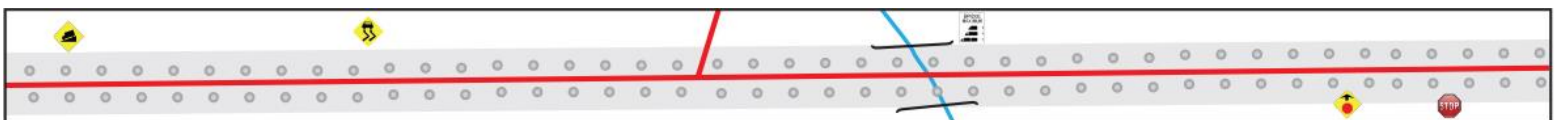

- Assets - Spatial points and lines with applicable text data (Assets must be within 100m of the vehicle & visible).
- GPS track (a series of points representing every location of the three camera perspectives).

### Why drive in 2 directions

- Glare from the Sun
- On-coming vehicles interfering with path
- 3 cameras + 2 directions = 6 visual perspectives for post processing

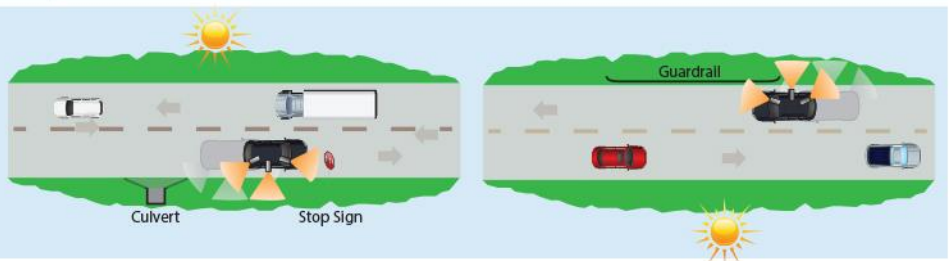

For more Information, please contact: M.D. of Bonnyville at 1-888-866-3171